

xiaomi Smart Lightstrip User Manual

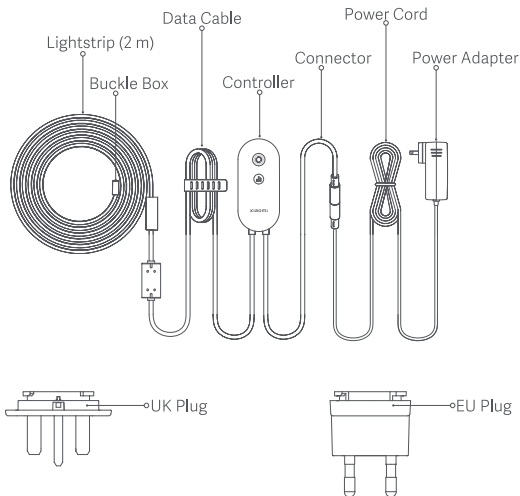

Product Overview

Read this manual carefully before use, and retain it for future reference.



Note: Illustrations of product, accessories, and user interface in the user manual are for reference purposes only. Actual product and functions may vary due to product enhancements.

How to Install

1. Align the **plug** with the power adapter and insert the **plug** into the power adapter. Then rotate the **plug** clockwise 45°. When you hear a click, the **plug** is installed successfully.

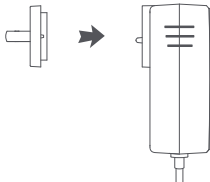

2. Before attaching the **lightstrip**, clean the surface where the **lightstrip** will be attached.

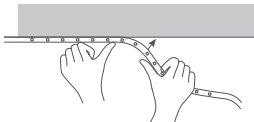

3. Connect the power cord with the connector of the **lightstrip**, and **plug** the power adapter into an electrical outlet.

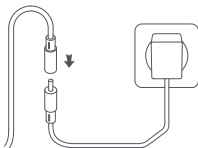

Note: You can purchase the Xiaomi Smart Lightstrip Extension separately to extend the lightstrip.

How to Use

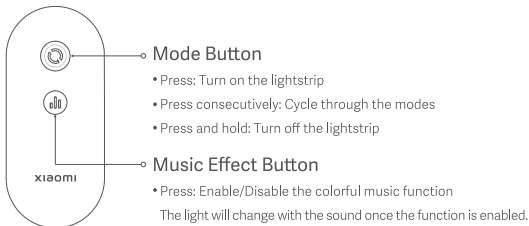

Connecting with Mi Home/Xiaomi Home App

This product works with the Mi Home/Xiaomi Home app*. Use the Mi Home/Xiaomi Home app to control your device, and to interact with other smart home devices.

Scan the QR code to download and install the app. You will be directed to the connection setup page if the app is installed already. Or search "Mi Home/Xiaomi Home" in the app store to download and install it. Open Mi Home/Xiaomi Home app, tap "+" on the upper right, and then follow prompts to add your device.

* The app is referred to as Xiaomi Home app in Europe (except for Russia). The name of the app displayed on your device should be taken as the default.

Note: The version of the app might have been updated, please follow the instructions based on the current app version.



1BCAA9AE

Apple HomeKit Smart Control

1. Open the Home app on your iPhone or iPad.
2. Tap "Add Accessories" and follow the instructions in the app to scan the QR code on the product base, or enter the 8-digit setup code above the QR code to grant the Apple Home app access.

Notes:

Make sure a Wi-Fi network with Internet access is available (this product does not support 5 GHz networks).

To control this HomeKit-compatible accessory, it is recommended that you use iOS 10.0 or above.



The HomeKit setup code is listed on the product base, do not lose it.

After restoring factory settings, you will need the HomeKit setup code again to add the accessory.

iPad and iPhone are the trademarks of Apple Inc., and they are registered in the United States and other countries.

Link a Lamp with Google Assistant

Add the Mi Home/Xiaomi Home service to the Google Assistant app, to control devices connected to Mi Home/Xiaomi Home from Google Assistant.

1. Tap  in the Google Assistant app, search for "Mi Home/Xiaomi Home", tap "Link", and sign in with your Xiaomi account.
2. Tap  in Settings > Home control to add a device, and follow the on-screen instructions. Once the accounts are linked, you can control the Lamp from Google Assistant.

Link a Lamp with Amazon Alexa

Add the Mi Home/Xiaomi Home skill to the Amazon Alexa app, to control devices connected to Mi Home/Xiaomi Home from Amazon Alexa.

1. Tap  in the Amazon Alexa app, then tap “Skills & Games”, search for “Mi Home/Xiaomi Home”, select the correct skill and tap “Enable”. Then sign in with your Xiaomi account.
2. After successfully linking the accounts, tap DISCOVER DEVICES to add the device, and follow the on-screen instructions. Once the accounts are linked, you can control the Lamp from Amazon Alexa.

Note: The name (Mi Home or Xiaomi Home) varies by selected language or regions.

Restoring Factory Settings

Simultaneously press and hold the mode button and the music effect button until the light starts to flow. When the flowing effect stops, the factory settings are restored successfully.

Note: When using the lightstrip in a new network environment, you need to restore the factory settings and connect it to the network again.

The Bluetooth® word mark and logos are registered trademarks owned by Bluetooth SIG, Inc. and any use of such marks by Xiaomi Inc. is under license. Other trademarks and trade names are those of their respective owners.

Specifications

Model: MJDD01YL

Power Factor: 0.4

Rated Input: 24 V $\overline{\text{---}}$ 0.21 A, 5.1 W (2 m) 24 V $\overline{\text{---}}$ 0.88 A, 21 W (10 m)

Rated Input (with adapter): 220–240 V~ 50/60 Hz, 0.05 A, 6.2 W (2 m)

220–240 V~ 50/60 Hz, 0.12 A, 24 W (10 m)

Wireless Connectivity: Wi-Fi IEEE 802.11 b/g/n 2.4 GHz,

Bluetooth 4.2 Bluetooth Low Energy

Compatible with: Android 4.4 & iOS 10.0 or above

Wi-Fi Operation Frequency: 2412–2472 MHz

Bluetooth Operation Frequency: 2402–2480 MHz

Wi-Fi Maximum Output Power: 18.95 dBm

Bluetooth Maximum Output Power: 4.81 dBm

Precautions

- Before using this product, please make sure your power supply's voltage is suitable for this product. Using this product with a voltage other than the one specified may damage the product and cause safety hazards.
-  For indoor use only.
- To prevent early product failures, the product should only be used in environments with a temperature range of 14 to 77°F (-10 to 25°C).
- Do not expose directly to water.
- Regularly check the cord, the power supply and all other parts for damage. If any part is damaged, the product should not be used.

- The lamps are not replaceable. When the light source reaches its end of life, the whole luminaire shall be replaced.
- Do not use the lightstrip when covered or recessed into a surface.
- Do not open or cut the lightstrip.
- The LED lightstrip should be used with the provided LED driver only.
- Do not disassemble the product, as the light diodes can cause damage to the eyes.
- This product is not a toy and should not be stored or left in locations accessible to young children.
- The lightstrip can be extended to 10 meters at most.
- Do not bend the LED inside the lightstrip more than 90 degrees to avoid damaging the product.
- Do not connect the lightstrip to the supply while it is in the packing or wound onto a reel.
- Do not connect parts of this lightstrip with parts of another manufacturer's lightstrip.
- Connections should only be made using the supplied connectors, and any open end should be sealed off before use.
- Under normal use of condition, this equipment should be kept a separation distance of at least 20 cm between the antenna and the body of the user.
- This lightstrip is not suitable for general indoor lighting, and can only be used for decorative purposes. You can use red light, green light, blue light, and other colored lights to create an atmosphere as needed at home.



UK Declaration of Conformity

Hereby, Qingdao Yeelink Information Technology Co., Ltd. declares that the radio equipment type MJDD01YL is in compliance with Radio Equipment Regulations 2017. The full text of the UK declaration of conformity is available at the following internet address:

<http://www.mi.com/uk/service/support/declaration.html>



EU Declaration of Conformity

Hereby, Qingdao Yeelink Information Technology Co., Ltd. declares that the radio equipment type MJDD01YL is in compliance with Directive 2014/53/EU. The full text of the EU declaration of conformity is available at the following internet address:

<http://www.mi.com/global/service/support/declaration.html>



WEEE Disposal and Recycling Information

All products bearing this symbol are waste electrical and electronic equipment (WEEE as in directive 2012/19/EU) which should not be mixed with unsorted household waste. Instead, you should protect human health and the environment by handing over your waste equipment to a designated collection point for the recycling of waste electrical and electronic equipment, appointed by the government or local authorities. Correct disposal and recycling will help prevent potential negative consequences to the environment and human health. Please contact the installer or local authorities for more information about the location as well as terms and conditions of such collection points.

Manufactured for: Xiaomi Communications Co., Ltd.

Manufactured by: Qingdao Yeelink Information Technology Co., Ltd.
(a Mi Ecosystem company)

Address: 10F-B4, Building B, Qingdao International Innovation Park, No.1
Keyuan Weiyi Road, Laoshan District, Qingdao City, Shandong
Province, P.R.China

For further information, please go to www.mi.com

User Manual Version: V1.0

Importer:

Beryko s.r.o.

Pod Vinicí 931/2, 301 00 Plzeň

www.beryko.cz